

The ProVia logo features a stylized white leaf icon to the left of the brand name "ProVia" in a bold, sans-serif font. Below the brand name, the tagline "THE PROFESSIONAL WAY" is written in a smaller, all-caps, sans-serif font.

ProVia
THE PROFESSIONAL WAY

BAY & BOW WINDOWS



BAY & BOW WINDOWS

AERIS™ | ENDURE™ | ASPECT™



STANDARD CONSTRUCTION

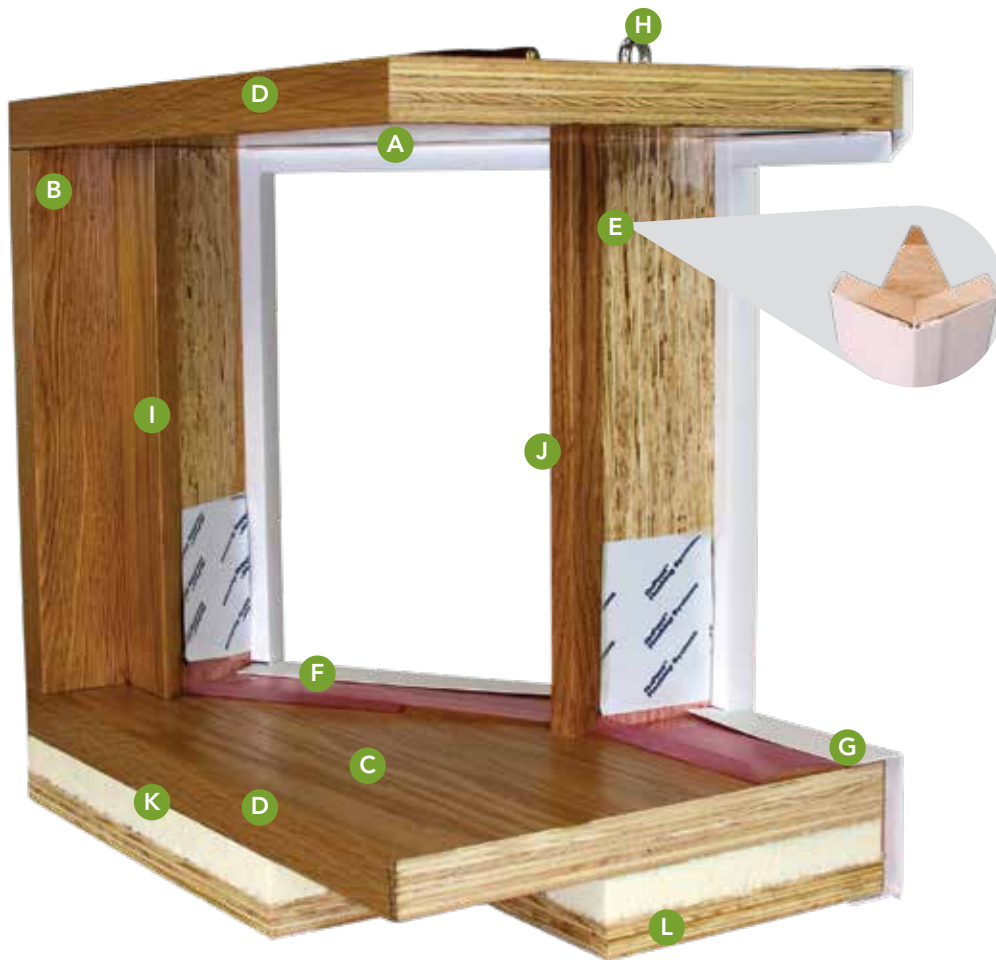

- A** **Head**
- B** **Side Jamb**
- C** **Seat Board:** 1¼" Furniture Grade Oak or Birch Veneer.
- D** **Edge Banding:** Exposed plywood interior edges of the head, seat and side jamb are covered with matching wood edge banding.
- E** Our **solid wood mullion** design is lag bolted to the head and seat for maximum strength and support. This unique design is made out of TimberStrand® laminated lumber.

TimberStrand is made from Aspen trees cut into thin strands and then dried and laminated together with a polyurethane resin. It is then pressed and steam injected to create a wood billet creating a strong and durable material that is 25% stronger than standard wood and will not absorb or release moisture.
- F** This **window panning system** is the ultimate protection against water infiltration. The PVC panning profiles wrap around and are adhered to the vertical mullions and seat board creating an interior gutter system.
- G** The **exterior is PVC wrapped**. Available colors: White, Beige, Sandstone, Classic Bronze and Coal Black.
- H** To ensure our windows will never bow or sag, we use adjustable **turn-buckled cable support system** to support the frame from the top with heavy-duty 6" hook and turnbuckle.
- I** **Side Wedge**
- J** **Mull Cap**
- K** **Fully Insulated** (Optional)
- L** **Insulate to Jamb** (Optional)

HEAD, SEAT & SIDE JAMBS FINISHING



STANDARD

- Unfinished Oak or Birch head, seat, side jamb & trim kit.
- On unfinished interiors, the trim kit will be shipped loose (optional factory install). Mullion Caps and side wedges will be factory installed.
- Head, seat and side jambs will have unfinished wood edge banding.

OPTIONAL

- Stained head, seat, side jamb, side wedges, mullion caps and trim kit.
- Painted head, seat, side jamb, side wedges, mullion caps and trim kit.
- Laminated head, seat & side jambs with painted side wedges, mullion caps and trim kit.
- Combination of painted or stained side wedges, mullion caps & trim kit in contrast with head, seat & side jabs.
- Finished trim kits with unfinished head, seat and side jambs are available. In this case, the trim kit will be finished to match the interior window color.

LAMINATE COLORS FOR HEAD, SEAT & SIDE JAMBS

High Pressure Plastic Laminate is a durable material that provides a maintenance free, scratch resistant and waterproof surface. This laminate is attached directly to a plywood base as shown in the image to the right.

White and Beige Laminate is available for the following:

Seat Boards only

- Units with laminated seat board only are available with finished or unfinished head, side jambs, side wedges, mullion caps & trim kits
- The head, seat & side jambs will always have laminate edge banding that matches the color of the seat board.

Head Board, Seat Board & Side Jambs

- Side wedges, mullion caps & trim kits will be painted White or Beige to match unless specified otherwise.
- The head, seat & side jambs will always have laminate edge banding that matches the color of the seat board.

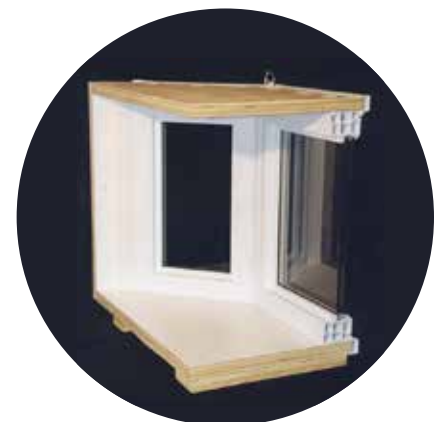

INTERIOR SHELL STAIN & PAINT FINISH OPTIONS

For all window color options, please refer to the window brochures.

OAK STAINS

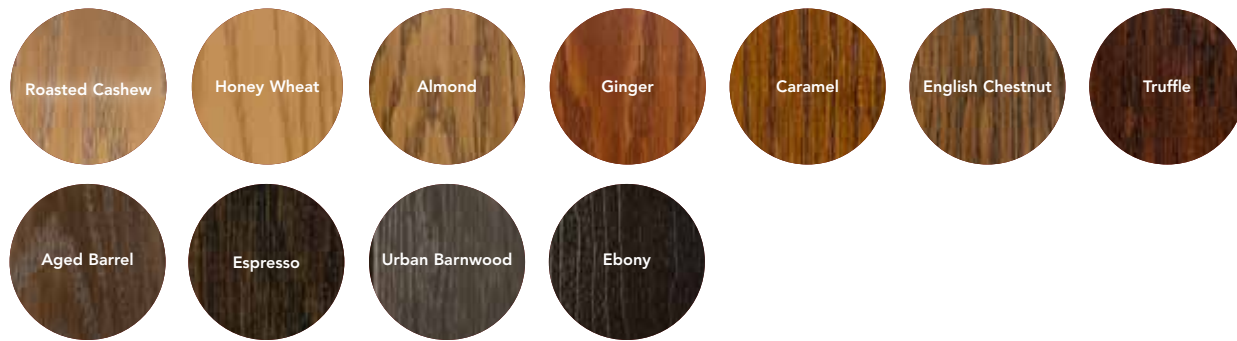

BIRCH STAINS



BIRCH PAINTS



EXTERIOR CLADDING COLORS



INTERIOR CASING

STAIN

All interior casing for Birch seat, head and side jambs will be Maple – stained to match head, seat and side jambs.

All interior casing for Oak seat, head, and side jambs will be Oak – stained to match head, seat, and side jambs.

PAINT

All interior casing will be Poplar – painted to match head, seat, and side jambs.



2 1/2" Modern



2 1/2" Colonial



3 1/2" Colonial



3 1/2" Flat

INSULATED SEAT BOARD OPTIONS

- **R-9 (standard)** - Features a unique layered design combining 1" high density Polyisocyanurate Insulator Board (Dow® Tuff-R™) and 3/4" exterior plywood surface.
- **R-21 (upgrade)** - Features a unique layered design combining 3" high density Polyisocyanurate Insulator Board (Dow THERMAX™) and 3/4" exterior plywood surface.
- **Non-insulated Seat Board**

- **Insulated to wall (standard)**
- **Fully Insulated Seat Board**
- Customize to insulate to a specific dimension from inside (to accommodate special situations)
- Insulated Head Board not available



3" OVERALL THICK INSULATED SEAT BOARD



5" OVERALL THICK INSULATED SEAT BOARD

STOP AT THE JAMB

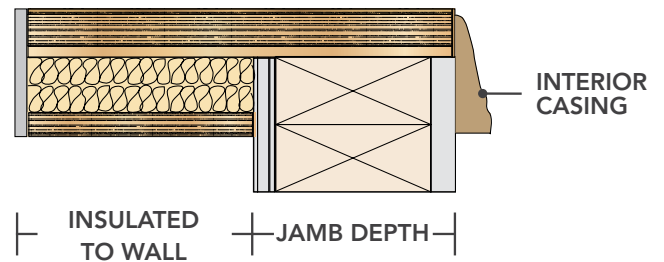

ENTIRE SEAT

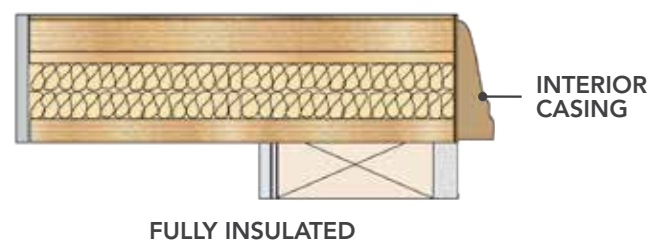

SUPPORT SYSTEMS

ADJUSTABLE, TURNBUCKLE CABLE HANGING SYSTEM

Hanging system comes standard on all bay & bow windows and eliminates the need for external knee braces. It can be secured to the soffit rafters or side wall studs and can be used with roof systems or Fascia extension applications.

Hanging support kit each has a 600 lb. working load limit. Kit includes two each of the following:

- Screw on eyehook mullion top
- $\frac{5}{16}$ " X 18" x $\frac{6}{32}$ " hook & hook turnbuckle
- 36" Length $1\frac{1}{8}$ " steel aviator cable & cable clamps
- $\frac{3}{8}$ " X 3" eye bolt lag screws

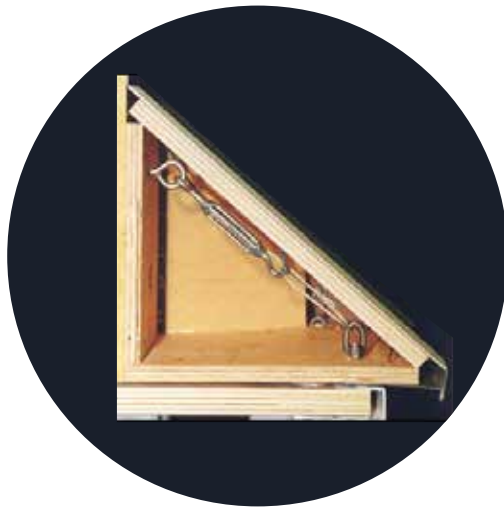

Hanging System used in conjunction with Wood Roof System



SPECIALTY BAY WINDOWS

A variety of specialty Bay Windows (i.e. Bump, Box, Hat, Walk-In, etc...) are available to order. Please contact ProVia Vinyl Window Customer Service for more information.



BRACE SYSTEMS

2" X 4" KNEE BRACE SUPPORT

Two 2" x 4" knee braces wrapped in white or beige vinyl are used to temporarily support the window until the cable support system is secured.

When installing knee brace support, always refer to our Bay & Bow Window Installation Instructions.



8 - #6 X 2" PHILLIPS PANHEAD SCREWS

DECORATIVE KNEE BRACES

Two knee braces with installation screwpack

Back and top made from 3/4" Poplar

Matches exterior window colors

Available from 6" to 24" long and wide in 2" increments (with 1 1/4" thickness)

Braces are symmetrical, downward leg is same as the projection

Two knee braces with installation screwpack

Back and top made from 3/4" Poplar

Matches exterior window colors

Available from 6" to 24" long and wide in 2" increments (with 2 1/2" thickness)

Braces are symmetrical, downward leg is same as the projection

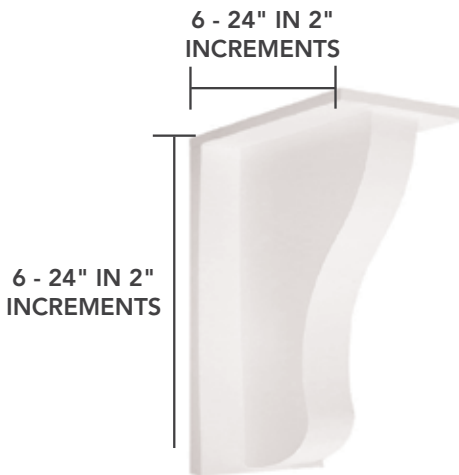

PLAIN FRONT EDGE

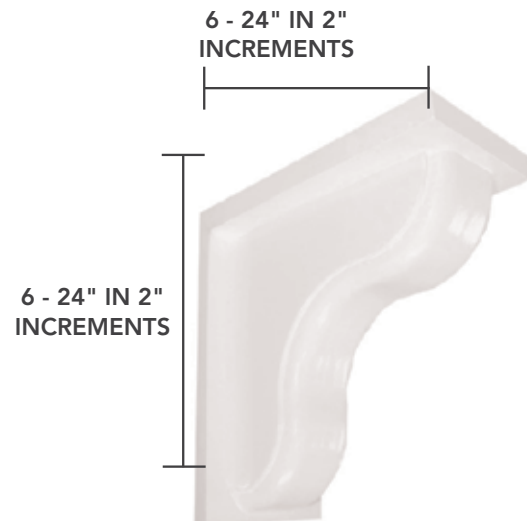

FLUTED FRONT EDGE



22 - Snap on caps



13 - #10 X 3" Phillips panhead screws



9 - #8 X 1 1/2" Phillips panhead screws

ROOF KITS

WOOD

- Easy to install
- Top panels are screwed into place and are easily removed to allow for installation of unit, cable support system, and insulation
- Pre-assembled hip style wood roof system (does not include flashing or shingles)
- ¾" Exterior Grade Plywood sheeting with 1¼" Plywood rafters
- 2" Overhang from the bay or bow frame
- Standard roof height is approximately two-thirds of exterior window projection



PAINTED ALUMINUM

- Includes Wood Roof Kit
- Easy to install - panels are pre-cut and slide into place
- Custom made to fit pre-assembled wood roof system
- .032" gauge painted aluminum features a premium Kynar
- 500®/Hylar® 5000 Glidden® Nubelar® finish that is available in 28 colors



COPPER

- Includes Wood Roof Kit
- Easy to install - panels are pre-cut and slide into place
- Includes pre-assembled wood roof system
- Custom made to fit pre-assembled wood roof system
- 16 oz. Copper available in a natural finish (aging will turn to Patina Green) or with an Inralac protective coating. Inralac coating preserves the "new penny" copper-look and can be re-applied to maintain a shiny finish



PRE-ASSEMBLED CONCAVE WOOD ROOF & CLAD KIT

- ¾" exterior grade plywood construction with 2 x 2 rafters
- Top panels are screwed into place and are easily removed to attach unit, complete hanging system assembly and insulate
- Standard roof back height is 12/12 pitch, back height equals the exterior projection of the window, plus 3 ½"
- Custom roof back height can be specified with no additional cost
- Roof system is designed with a 3 ½" Overhang (Soffit) and Fascia, as well as custom sizes



PAINTED ALUMINUM ROOF COLORS

Several colors are available.
Order part #: S-MK-31012 to see all color options.

